

ROCKY POINT ROAD KOGARAH

DEVELOPMENT APPLICATION
NOV 2017_S

ARCADIA
LANDSCAPE ARCHITECTURE



0.0_CONTENTS

SITE UNDERSTANDING

1.1_context

1.2_local vernacular

1.3_solar analysis

1.4_enviromental analysis

DESIGN VISIONING

2.1_principles

2.2_character

2.3_inspiration

DESIGN RESPONSE

3.1_masterplan

3.2_veg management plan

3.3_soil depth

3.4_deep soil option 1

3.5_networks

3.6_roofterraces

3.7_detail plans

3.8_sections and illustrations

3.9_material strategy

3.10_planting strategy

APPENDIX

200_masterplan

400_softscape plans

500_typical details

1.0 SITE UNDERSTANDING



1.1 SITE UNDERSTANDING_CONTEXT



The Site, is located at the centre of the St George District, just 15 kilometres south of the Sydney CBD and 5 kilometres south west of Sydney’s Kingsford Smith International and Domestic Airports.



The site is located south of Kogarah town centre with frontage onto Rocky Point Road. The urban neighbourhood character of Rocky Point Road and west of Scarborough Park and Leo Smith Reserve, consists of low rise residential and industrial buildings. Importantly St George Hospital and St George TAFE dominate the region, being located on higher ground adjacent to Kogarah town centre.



To the immediate north of the site is an industrial precinct defined by a number of low-rise warehouse buildings. To the east of the site are a sequence of open landscape spaces associated with a chain of wetlands. To the immediate south and west of the site and west of Rocky Point Road, the urban pattern becomes more suburban defined by free standing houses. With Rocky Point Road aligned north south, the pattern of the local streets which make

1.2 SITE UNDERSTANDING_LOCAL VERNACULAR

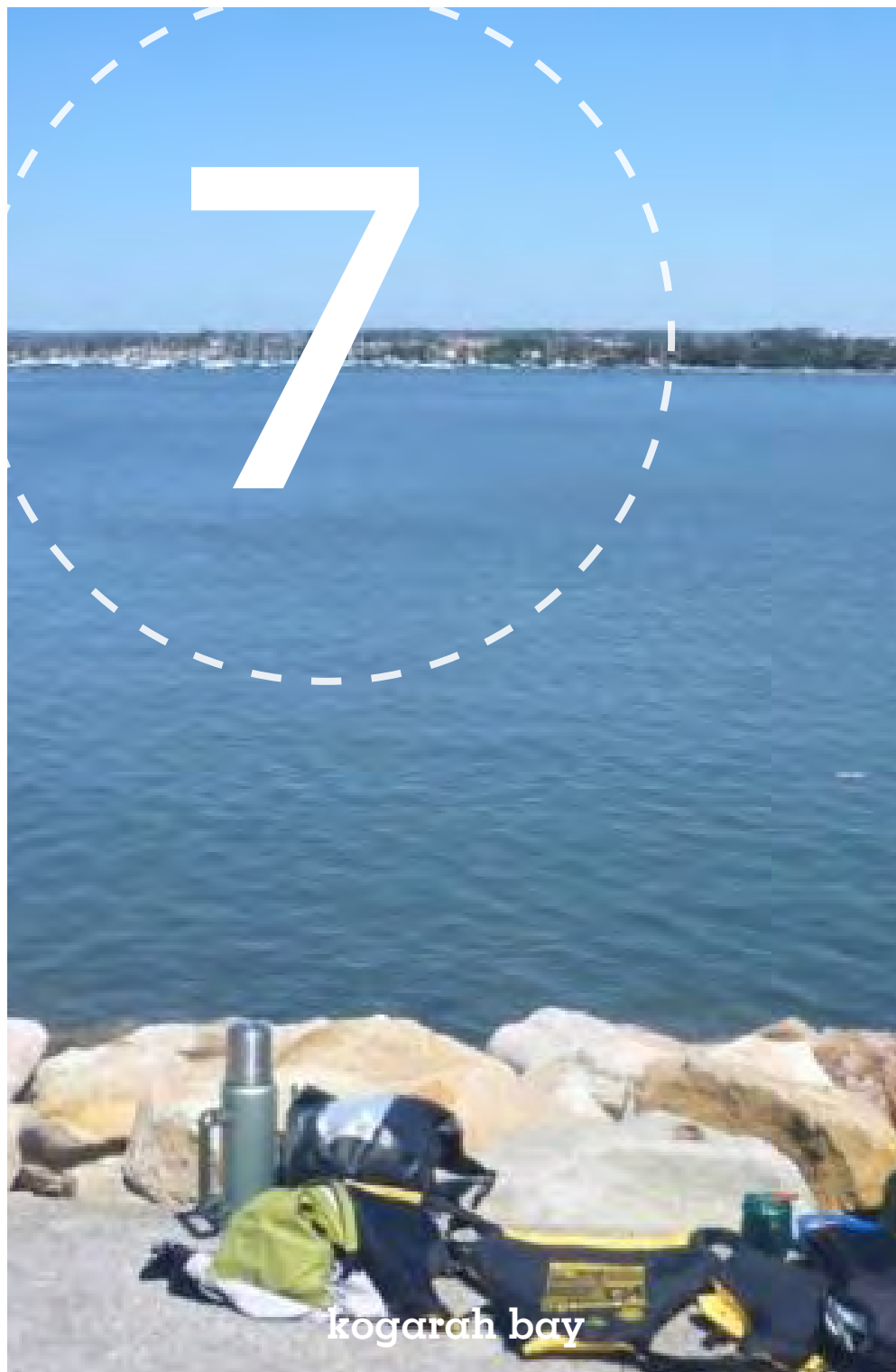
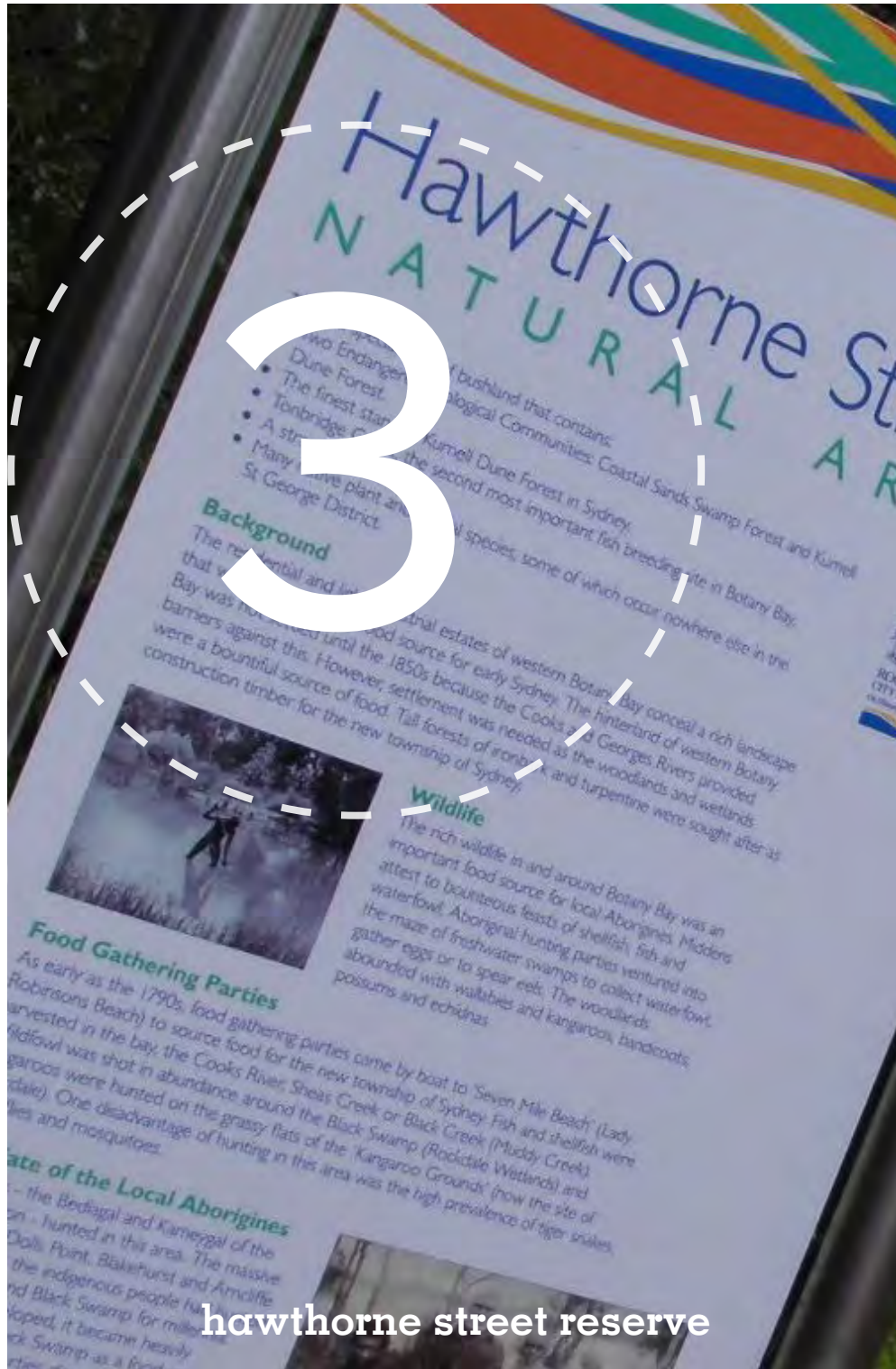

1.3 SITE UNDERSTANDING_SHADOW ANALYSIS

9AM JUNE



MIDDAY JUNE



3PM JUNE



9AM DEC

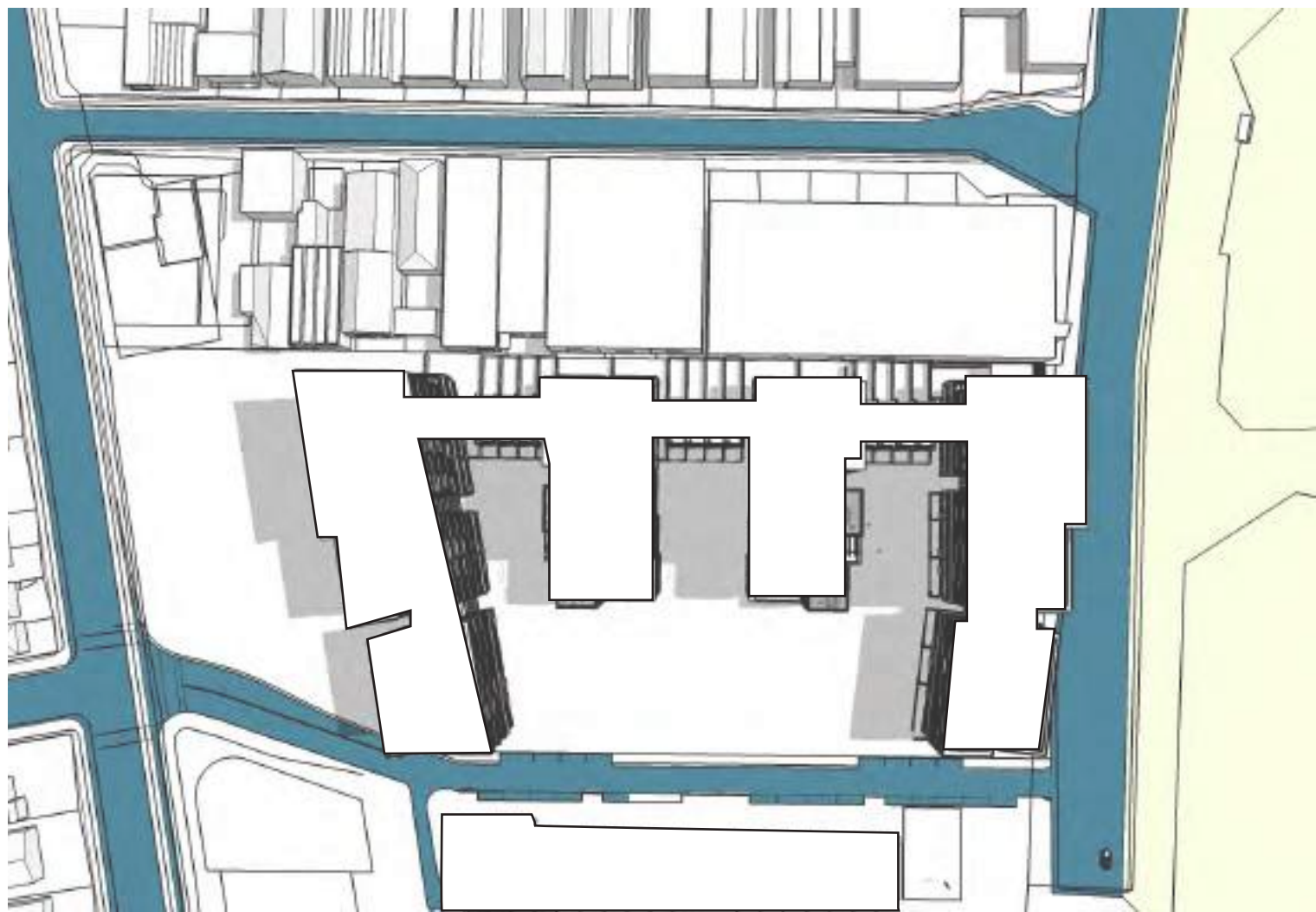

MIDDAY DEC

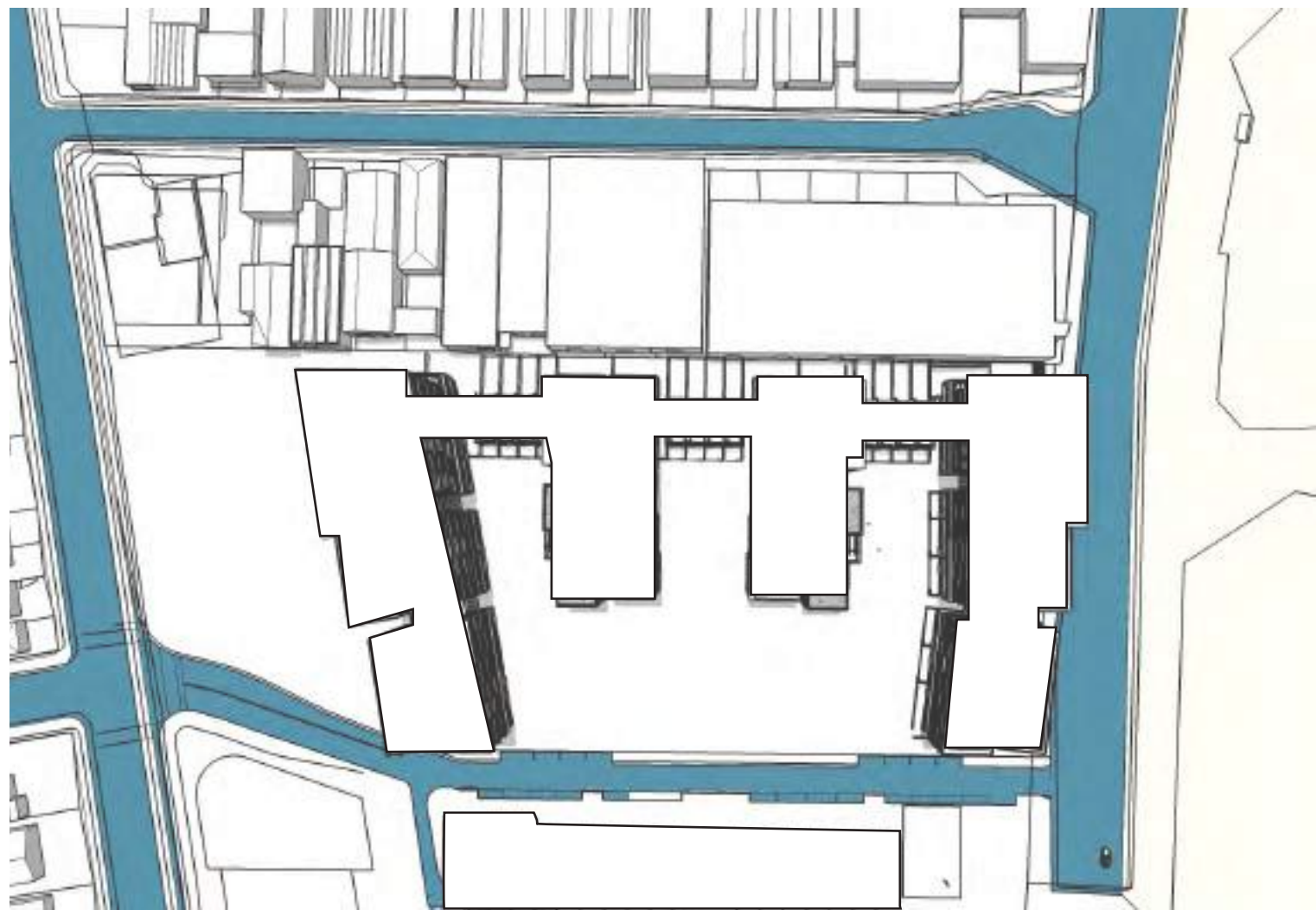

3PM DEC

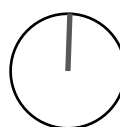
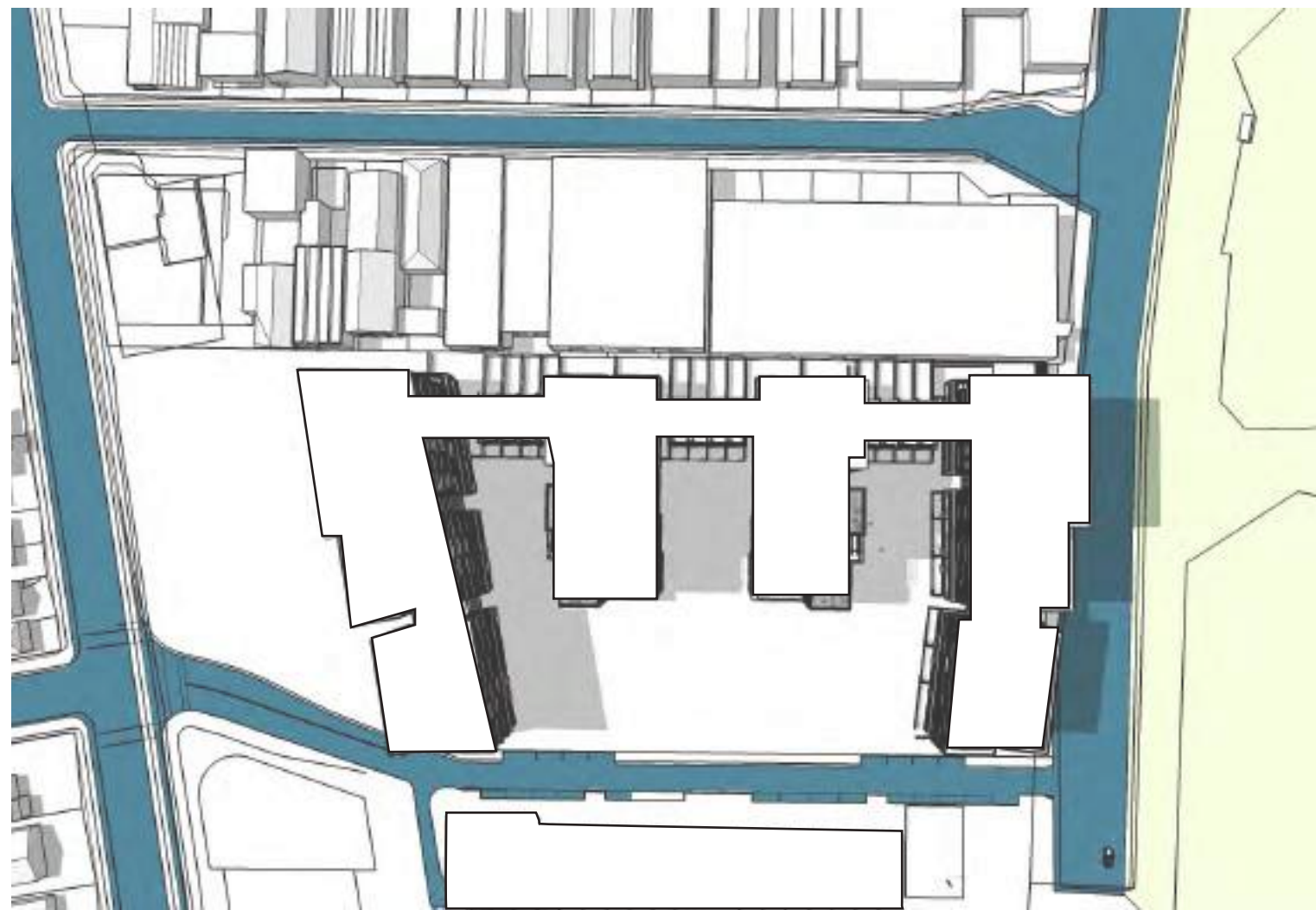

1.4 SITE UNDERSTANDING_ENVIRONEMNTAL ANALYSIS

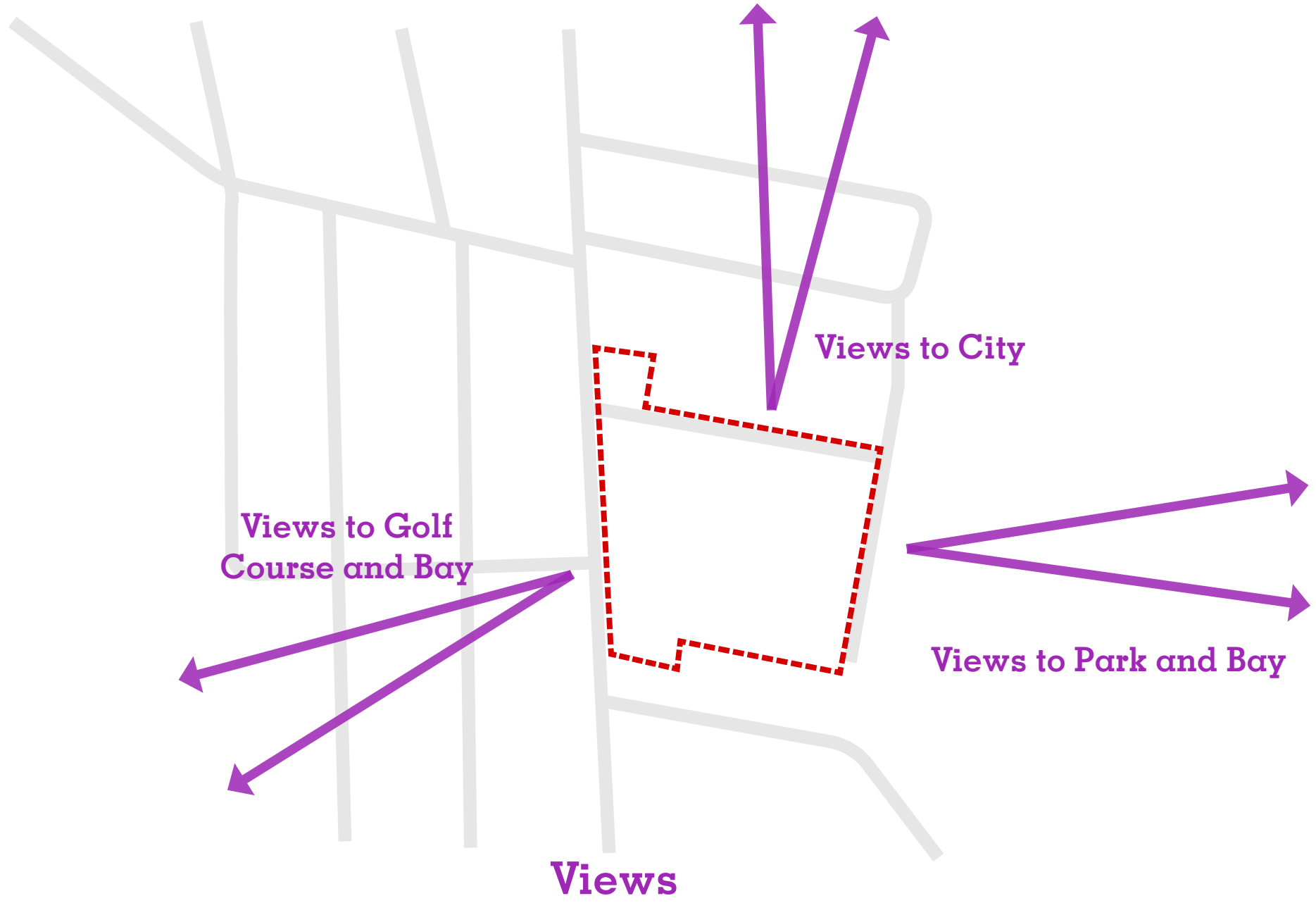
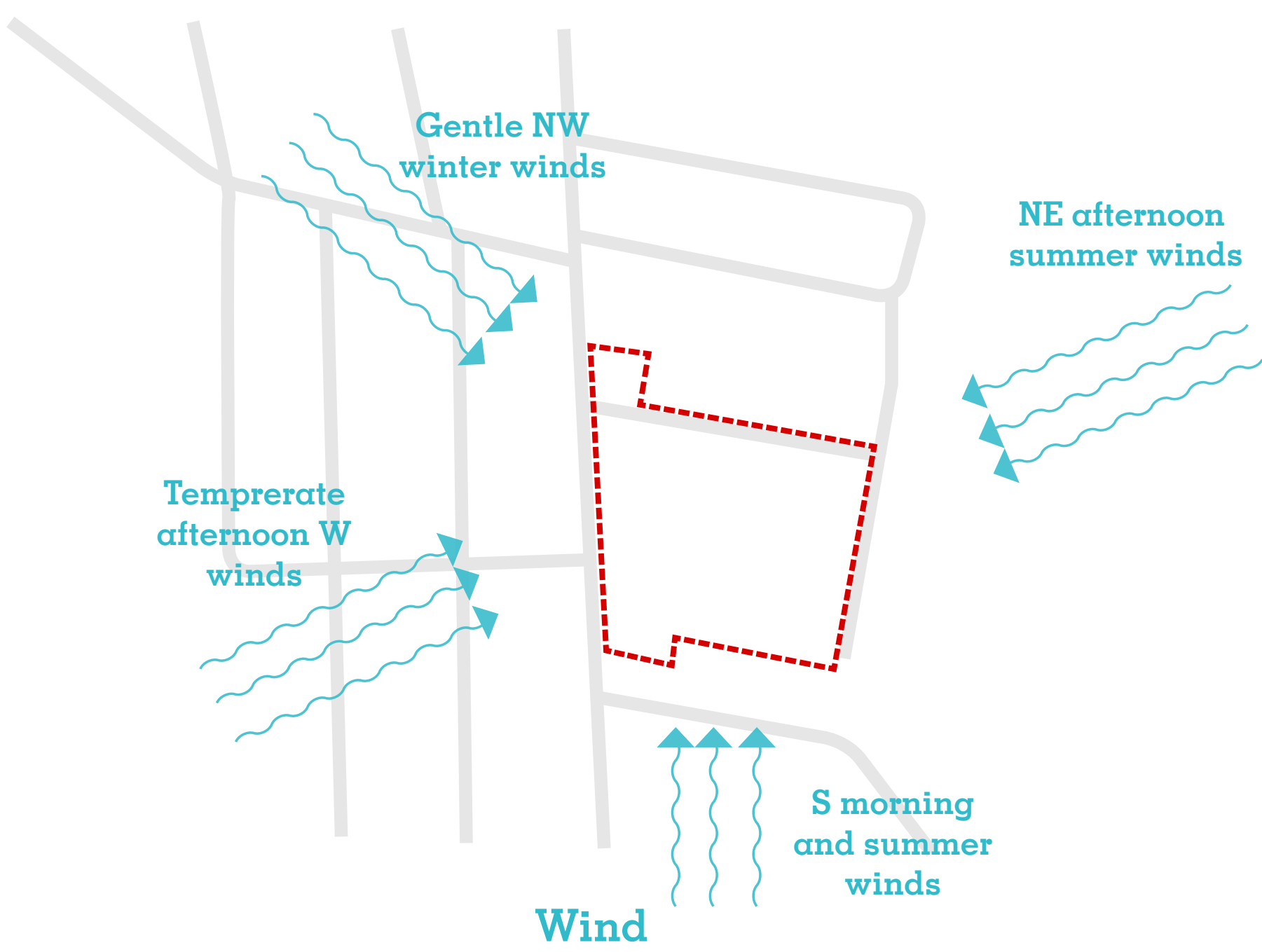
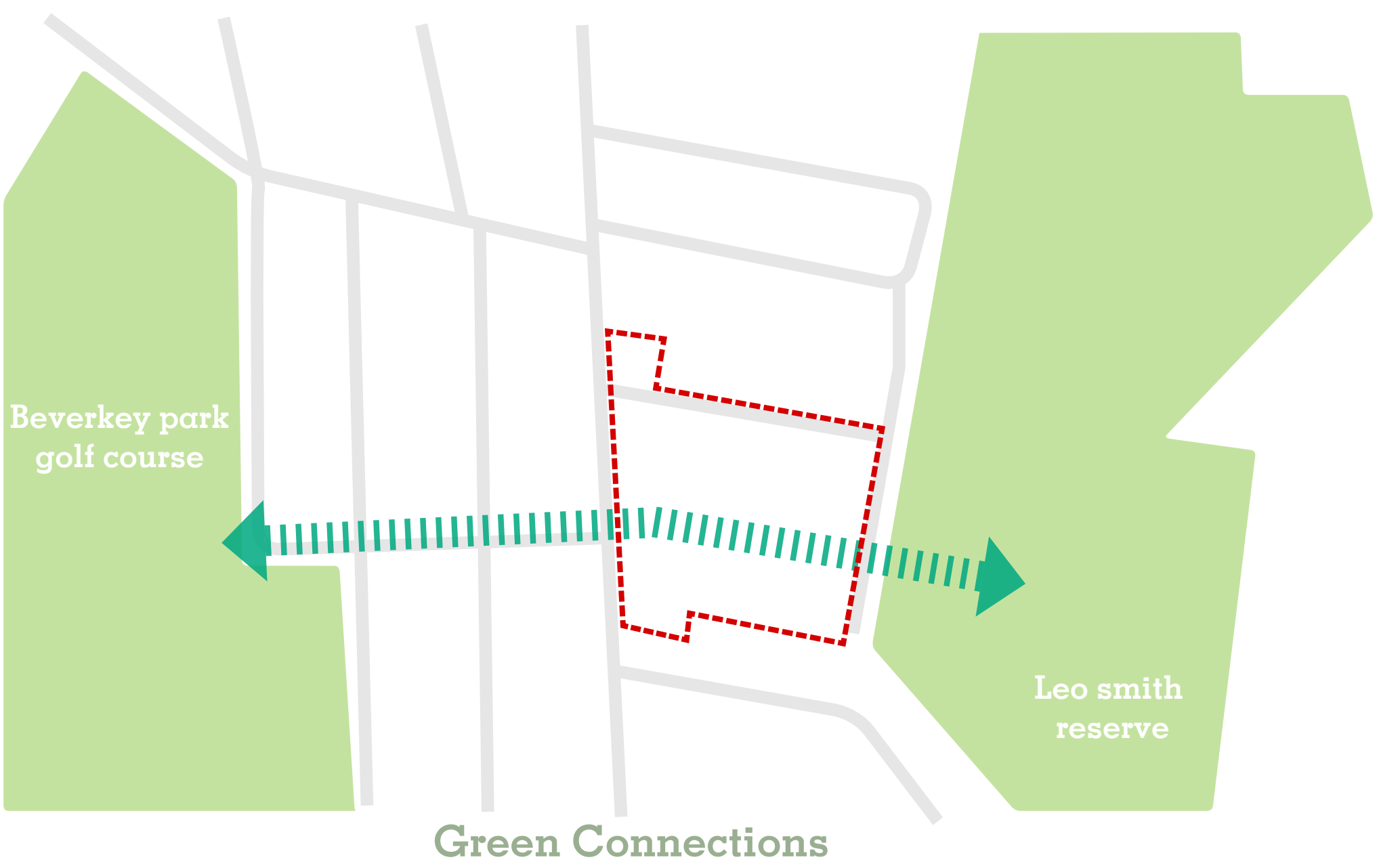
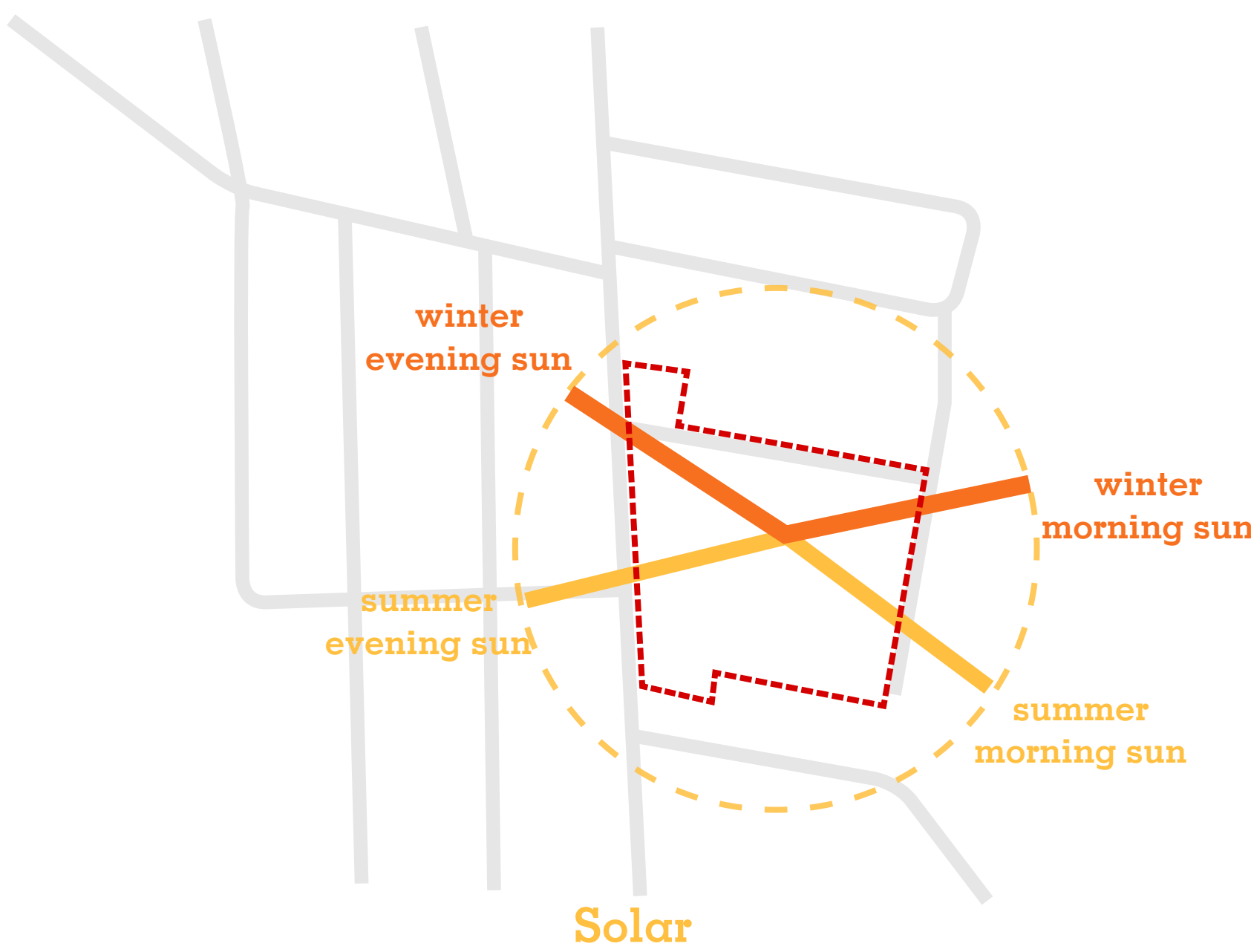

2.0 DESIGN VISIONING



2.1 DESIGN VISIONING DESIGN PRINCIPLES

Connecting Amenity

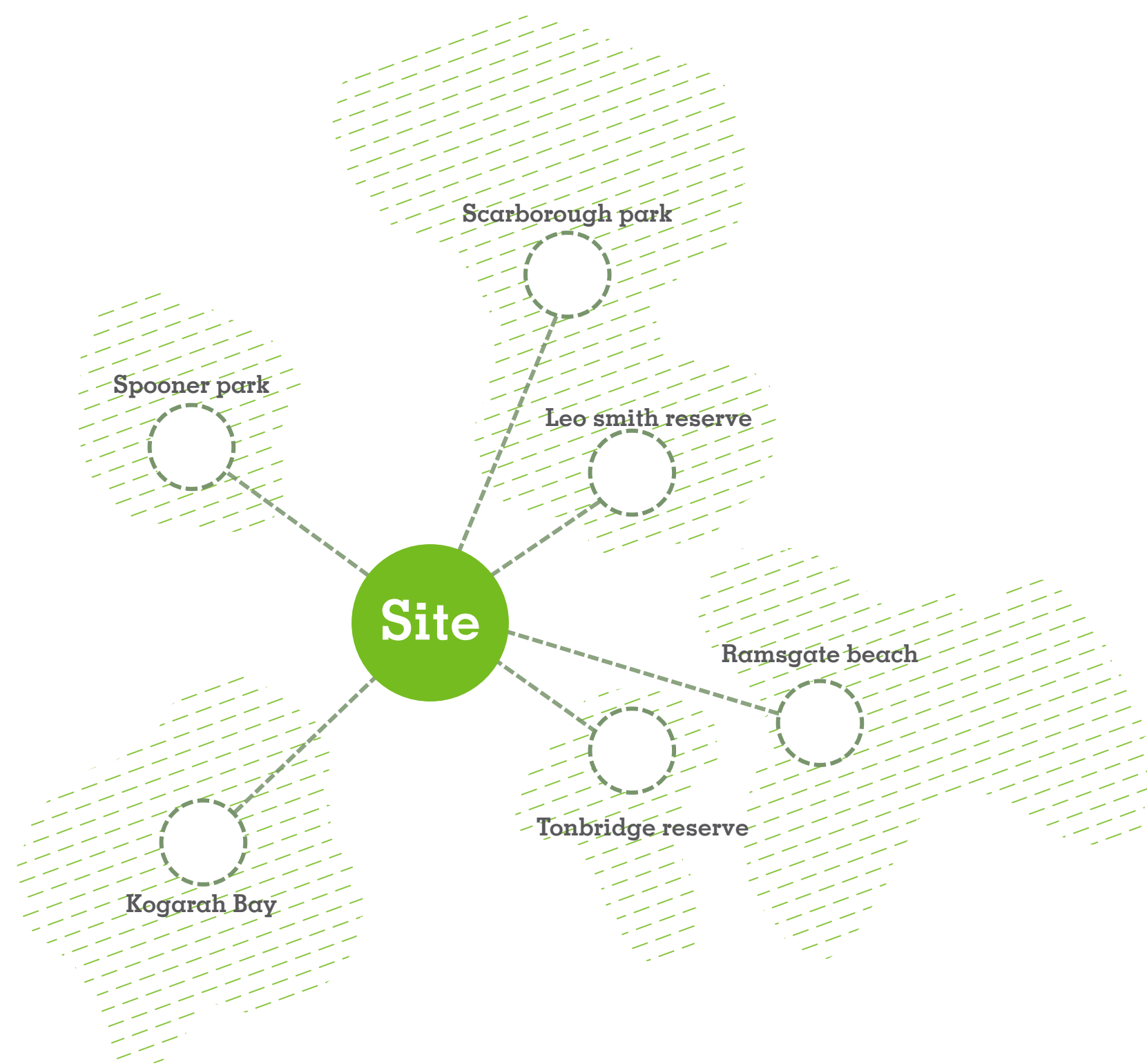

Central to the structure is a focus on creating a healthy living community incorporating all aspects of wellbeing – physical, mental and social. Sitting in the middle of a diverse range of public amenity, the site will play a pivotal role in connecting these recreational spaces together.

A Place for Play

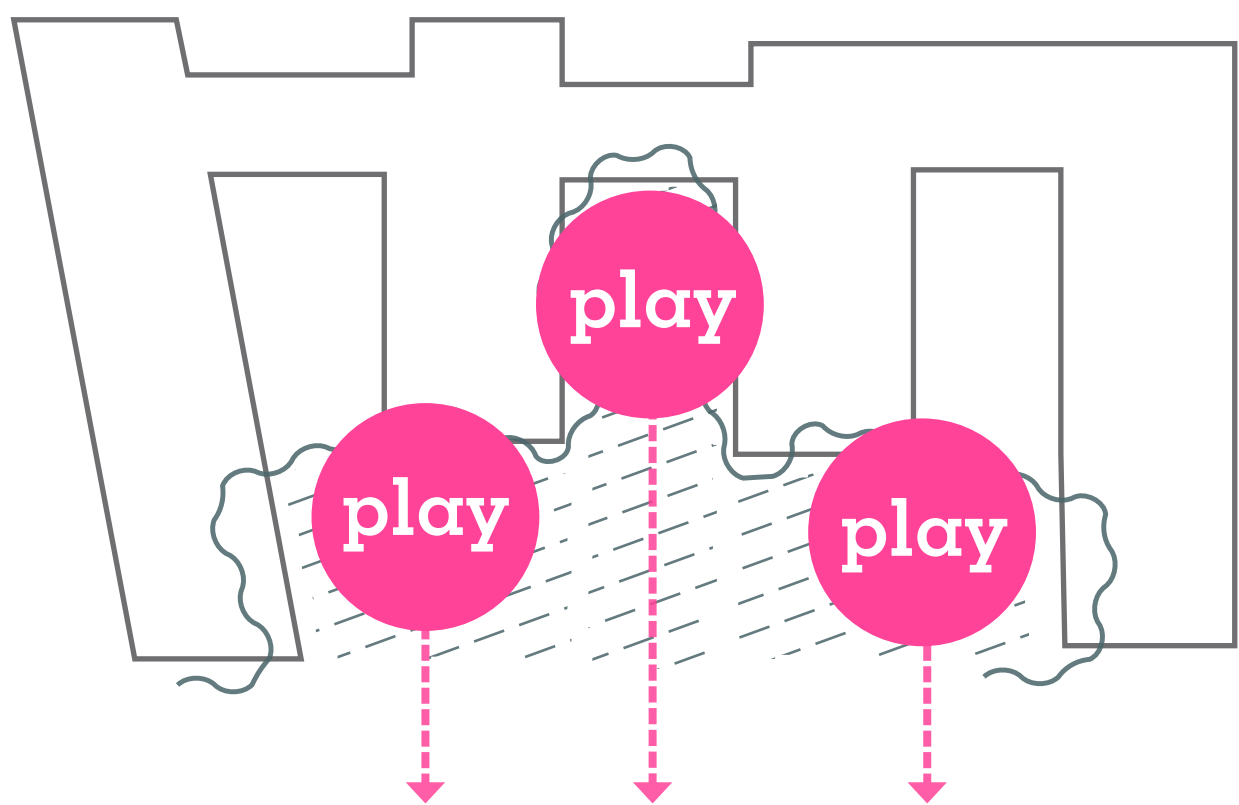

The diverse collection of spaces provided within the public realm places a strong emphasis on the outdoors, recreation and social engagement. Passive and active recreation, playfulness, colour and whimsy will be scattered throughout the public domain.

Reinstate Natural Areas

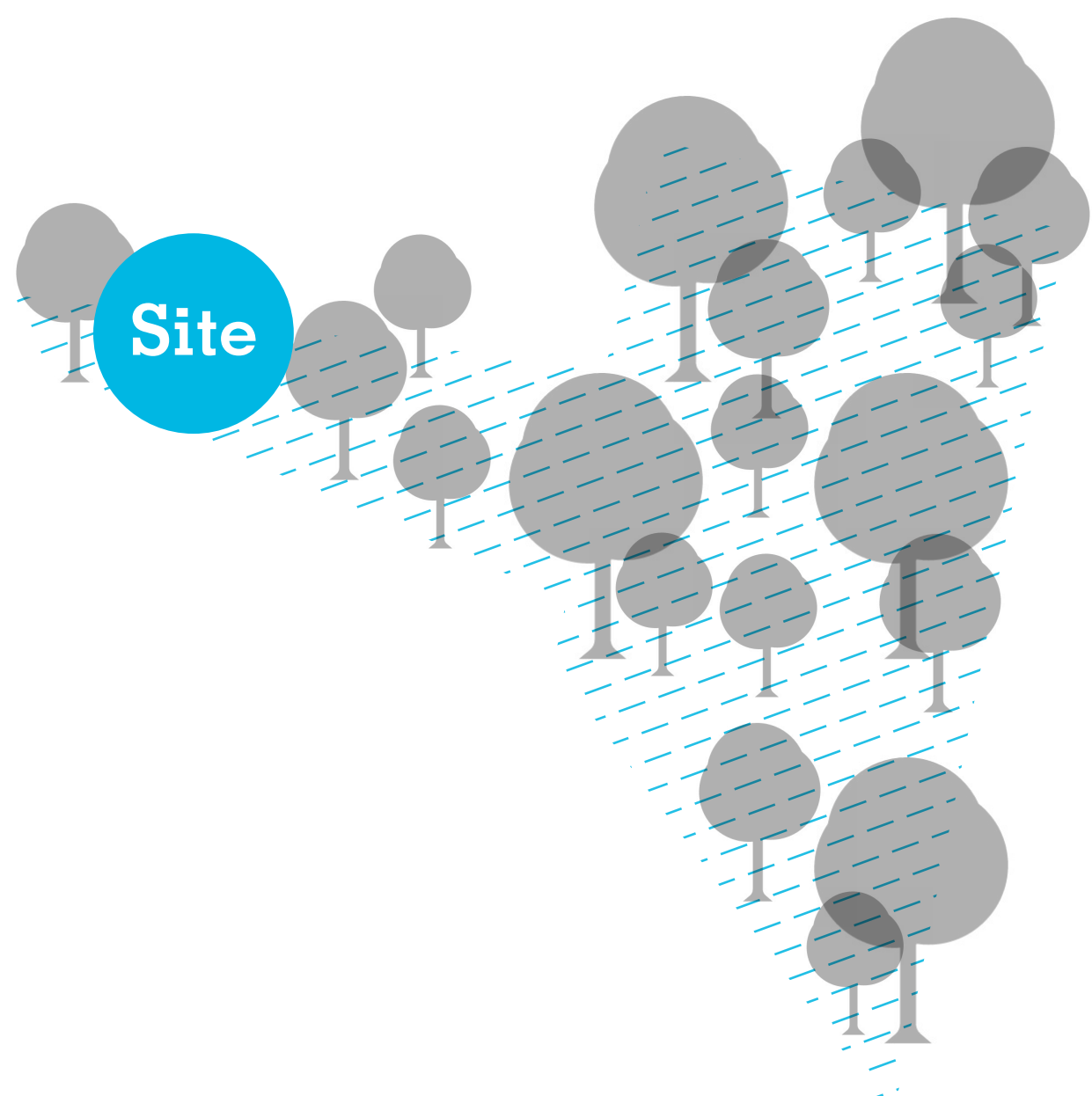

Drawing upon the existing woodland remnants within the Hawthorne Street Natural Area will contribute to native vegetation corridors improving quality of life as the area becomes increasingly urbanised. bringing this landscape language into the site will improve quality of life.

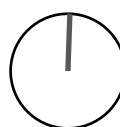

2.2 DESIGN VISIONING_CHARACTER

Connected to natual surrounds



Inviting to the public



Allowing privacy



Embracing play



Celebrating the views



Coastal character



2.3 DESIGN VISIONING_INSPIRATION

Proposed Colour palette

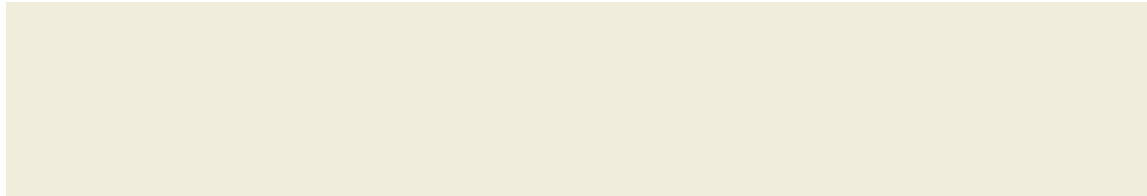

Coastal materiality



Secluded outlook

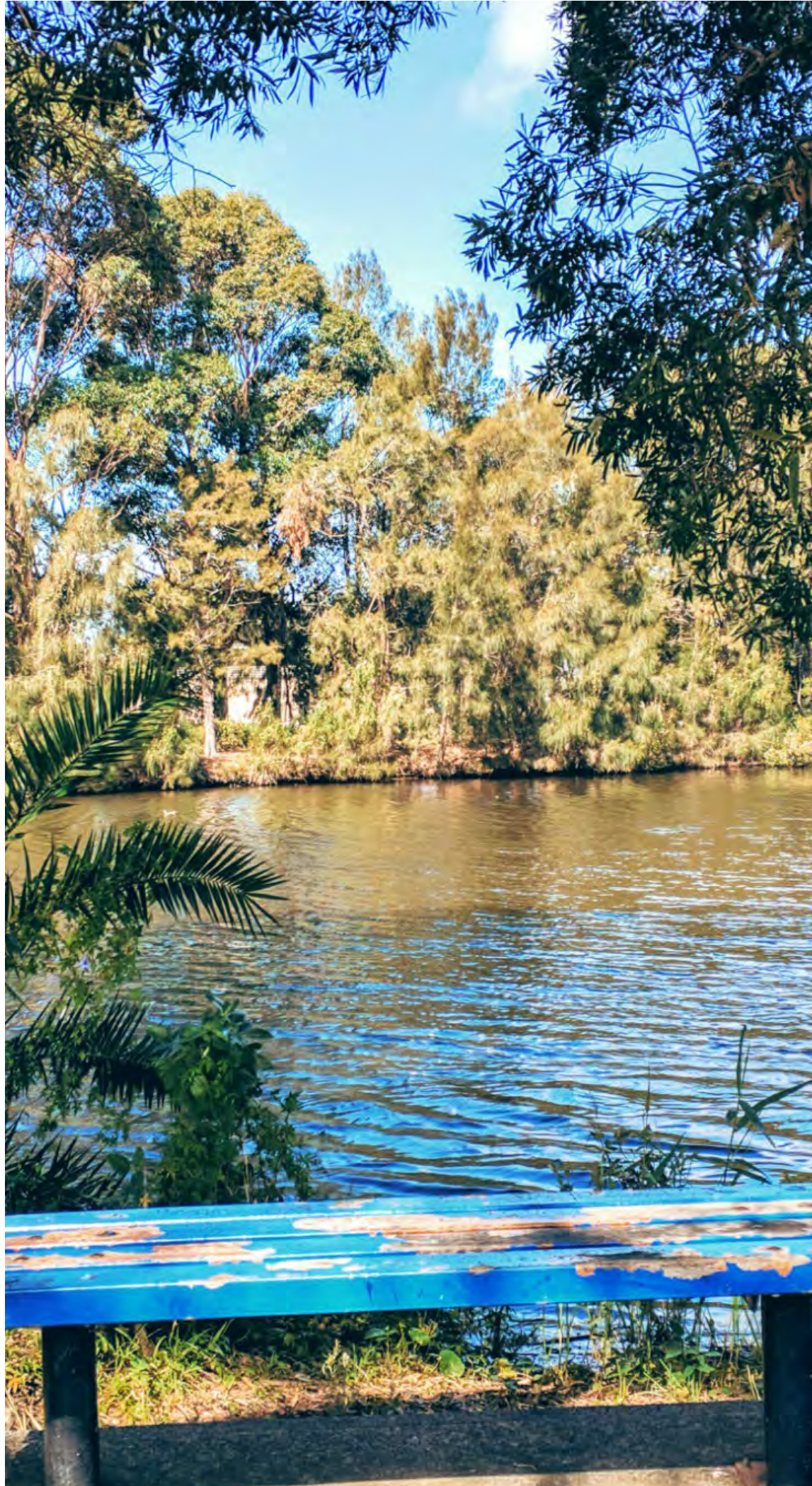

Boulevard planting



The natural edge



Kurnell Dune Forest,



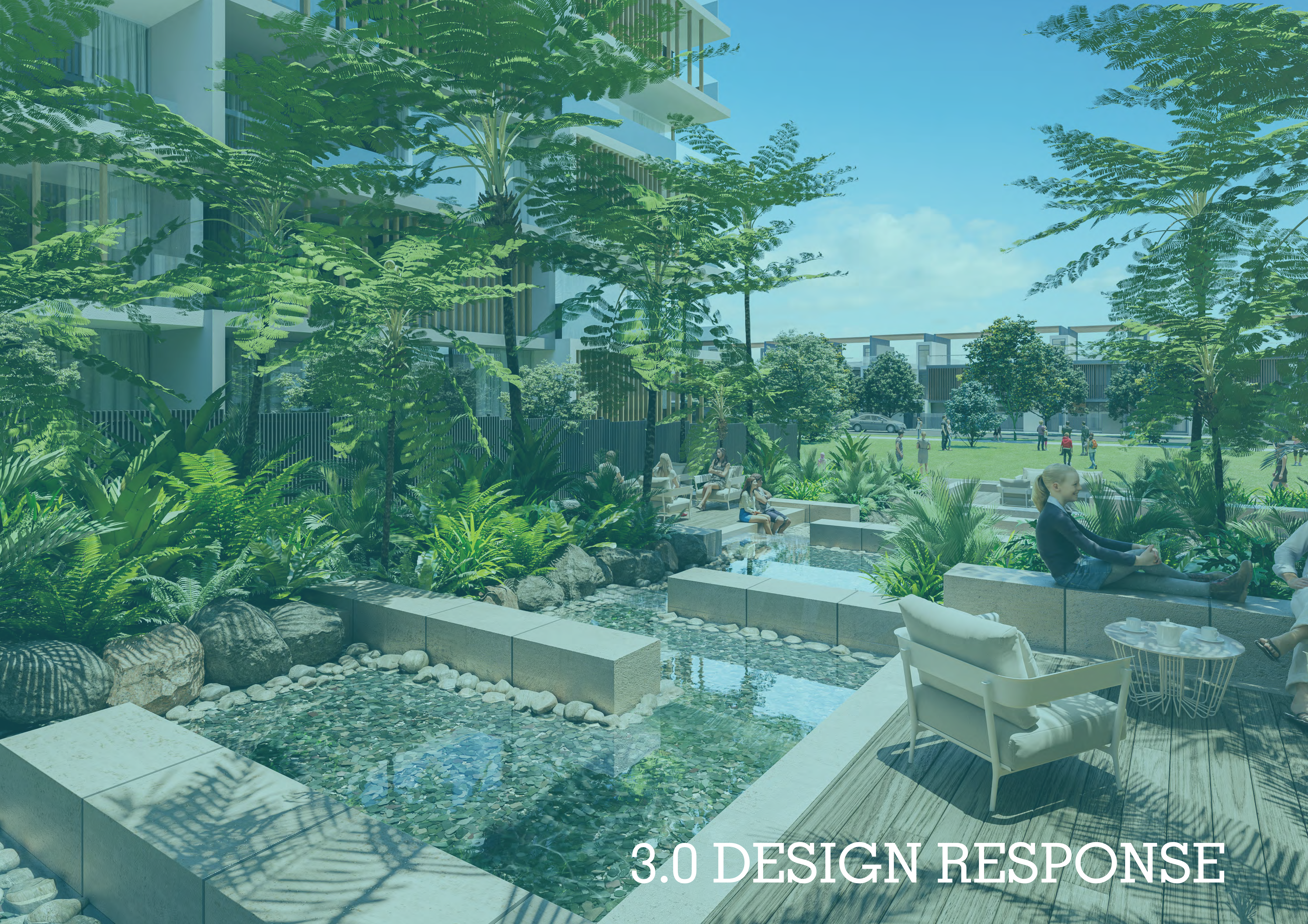

3.0 DESIGN RESPONSE

3.1 DESIGN RESPONSE_MASTERPLAN



- 01 / Private residential courtyards
- 02 / lobby access
- 03 / Kick about space with spectator embankment
- 04 / Urban retreat Rainforest
- 05 / Deep soil zone with mature trees and egress path
- 06 / Parallel parking
- 07 / Roof terrace
- 08 / Cycleway cross
- 09 / BBQ area
- 10 / Security Line on sandstone wall
- 11 / Rainforest water feature
- 12 / Childcare site by others
- 13 / Shared zone
- 14 / Dry creek bed
- 15 / Playground
- 16 / Cycleway
- 17 / Roof garden

3.2 DESIGN RESPONSE_VEGETATION MANAGEMENT PLAN



-  Trees to be retained
-  Trees to be removed - 82 Trees
-  Proposed trees - 164 Trees

